

SQUARE FOOTAGES

FIRST FLOOR	-	1871 S.F.
SECOND FLOOR	-	1381 S.F.
TOTAL A/C	-	3252 S.F.
GARAGE	-	417 S.F.
PORCH	-	95 S.F.
LANAI	-	178 S.F.
2ND FLOOR DECK	-	340 S.F.
TOTAL UNDER ROOF	-	4282 S.F.

FIRST FLOOR NOTES

DEEB FAMILY HOMES, LTD.
 9400 RIVER CROSSING BLD.
 NEW PORT RICHEY, FL. 34655
 727-376-6831

PLAN DATE
 05-25-18

INVENTORY LOT 21 SAFETY HARBOR

A.E.C.S. 00000

HEREBY CERTIFY THAT I HAVE PERFORMED THE ATTACHED DESIGN TO COMPLY WITH 145 MPH ULTIMATE WIND LOADS AND IT IS IN COMPLIANCE WITH SECT. 301 OF THE 2017 FLORIDA RESIDENTIAL BUILDING CODE SEALED FOR STRUCTURE ONLY
 SIGNED RICHARD E. ALLEN P.E. #56920

MODEL 3252

ALLEN ENGINEERING & CONSTRUCTION SERVICES
 RICH ALLEN PROFESSIONAL ENGINEER
 P.E. # 56920 C.A. # 9542
 8809 SKYMASTER DR.
 NEW PORT RICHEY, FL. 34654
 727-842-6100
 richallenpe@gmail.com

2

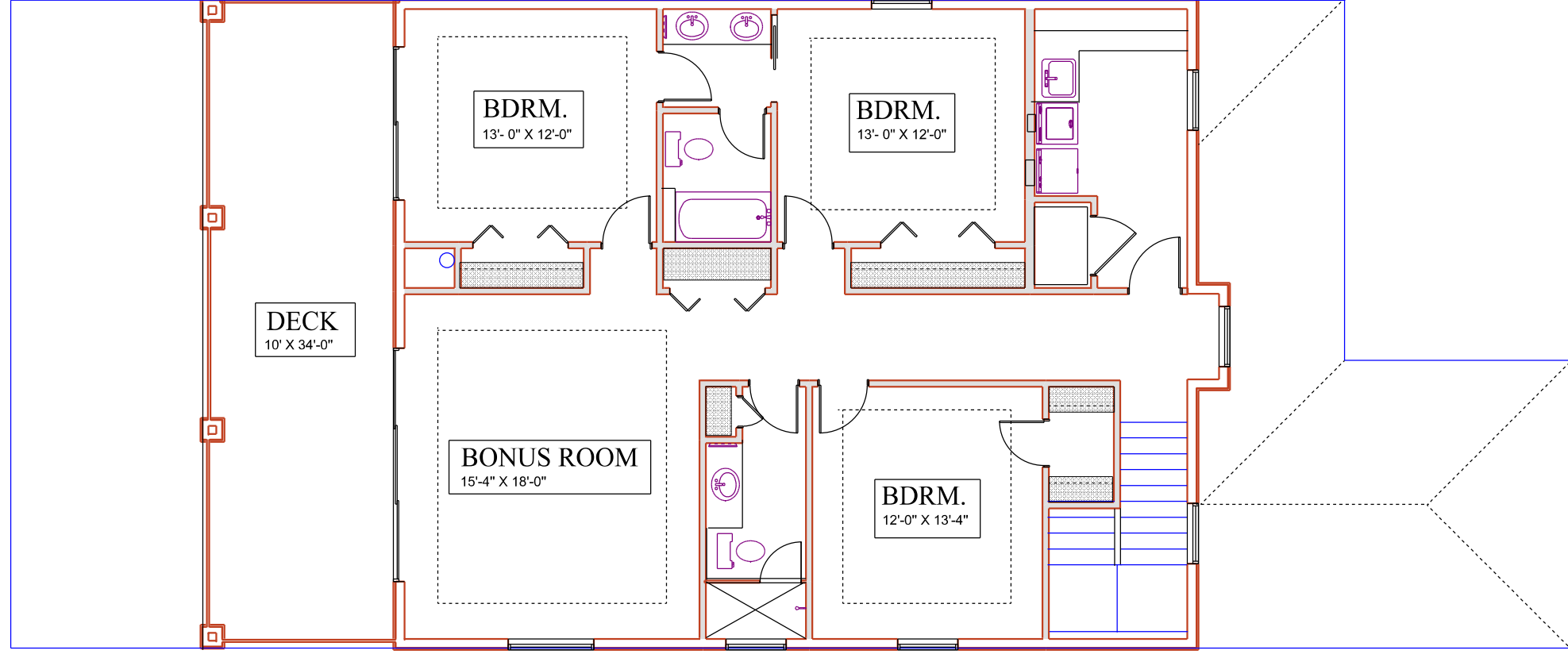

SECOND FLOOR NOTES

SCALE 1/8" = 1'-0"

3

DEEB FAMILY HOMES, LTD.
 9400 RIVER CROSSING BLD.
 NEW PORT RICHEY, FL. 34655
 727-376-6831

PLAN DATE
 05-25-18

INVENTORY LOT 21 SAFETY HARBOR

A.E.C.S. 00000

HEREBY CERTIFY THAT I HAVE PERFORMED THE ATTACHED DESIGN TO COMPLY WITH 145 MPH ULTIMATE WIND LOADS AND IT IS IN COMPLIANCE WITH SECT. 301 OF THE 2017 FLORIDA RESIDENTIAL BUILDING CODE SEALED FOR STRUCTURE ONLY
 SIGNED RICHARD E. ALLEN P.E. #56920

MODEL 3252

ALLEN ENGINEERING & CONSTRUCTION SERVICES
 RICH ALLEN PROFESSIONAL ENGINEER
 P.E. # 56920 C.A. # 9542
 8809 SKYMASTER DR.
 NEW PORT RICHEY, FL. 34654
 727-842-6100
 richallenpe@gmail.com