

**ELECTRICAL LEGEND**

\$	SINGLE POLE SWITCH	⊕	SMOKE DETECTOR / CARBON MONOXIDE DETECTOR
\$2	DOUBLE POLE SWITCH	☀	FLOOD LIGHT
\$3	THREE-WAY SWITCH	⎓	FLUORESCENT LIGHTING
\$4	FOUR-WAY SWITCH	⎓	TRACK LIGHTING
\$DM	DIMMER SWITCH	☪	CEILING FAN
⊙	CEILING FIXTURE	CHIMES	DOOR BELL CHIMES
⊙	SCOUNCE ( WALL MOUNTED ) FIXTURE	DISP	DISPOSAL
⊕	110 VOLT DUPLEX OUTLET	DISC	DISCONNECT SWITCH
⊕	110 VOLT SPLIT SWITCHED OUTLET	SP	PREWIRE SPEAKER
⊕	GROUND FAULT INTERRUPT	J	JUNCTION BOX
⊕ WP	WATER PROOF W/ GROUND FAULT	T	THERMOSTAT
⊕	220 VOLT OUTLET	⊕	LOW VOLTAGE LIGHTING
⊕	SPECIAL SERVICES OUTLET	IC	INTERCOM SYSTEM
TV	T.V. CABLE OUTLET	PB	GARAGE DOOR PUSH BUTTON
⊕	TELEPHONE CABLE OUTLET		
⊕	RECESSED LIGHTING		
⊕ WP	WATER PROOF RECESSED LIGHTING		
⊕	BATH FAN		
⊕	BATH FAN W/ LIGHT		

UNLESS OTHERWISE NOTED

1. ELECTRICAL OUTLET HEIGHTS MEASURED FROM FINISHED FLOOR TO CENTERLINE OF THE BOX TO BE 18" A.F.F. ( GENERAL )

2. ALL TRIM PLATES AND DEVICES TO GANGED WHERE POSSIBLE

3. ELECTRICAL SWITCHES TO BE AT 42" CENTERLINE A.F.F.

4. ELECTRICAL PLAN IS INTENDED FOR BID PURPOSES ONLY. ALL WORK SHALL BE DONE IN STRICT ACCORDANCE WITH THE NATIONAL ELECTRICAL CODE, LATEST EDITION BY A LICENSED ELECTRICAL CONTRACTOR WHO SHALL BE RESPONSIBLE FOR THE INSTALLATION & SIZING OF ALL ELECTRICAL, WIRING & ACCESSORIES.

5. SMOKE DETECTORS SHALL BE IN ACCORDANCE WITH THE FLORIDA BUILDING CODE, SECTION 907.2

6. PROVIDE AFCI ( ARC FAULT INTERRUPTERS ) IN ALL AREAS PER NEC, SECTION 210-12

7. ALL RECEPTALS TO BE TAMPER PROOF PER SECT. 406.11

42" KITCHEN

42" BATHROOM

42" LAUNDRY

36" WASHER/ 24" DRYER/ WALL OUTLETS 45" WATERPROOF @ 12"

GFI @ 45"

220V @ 4"

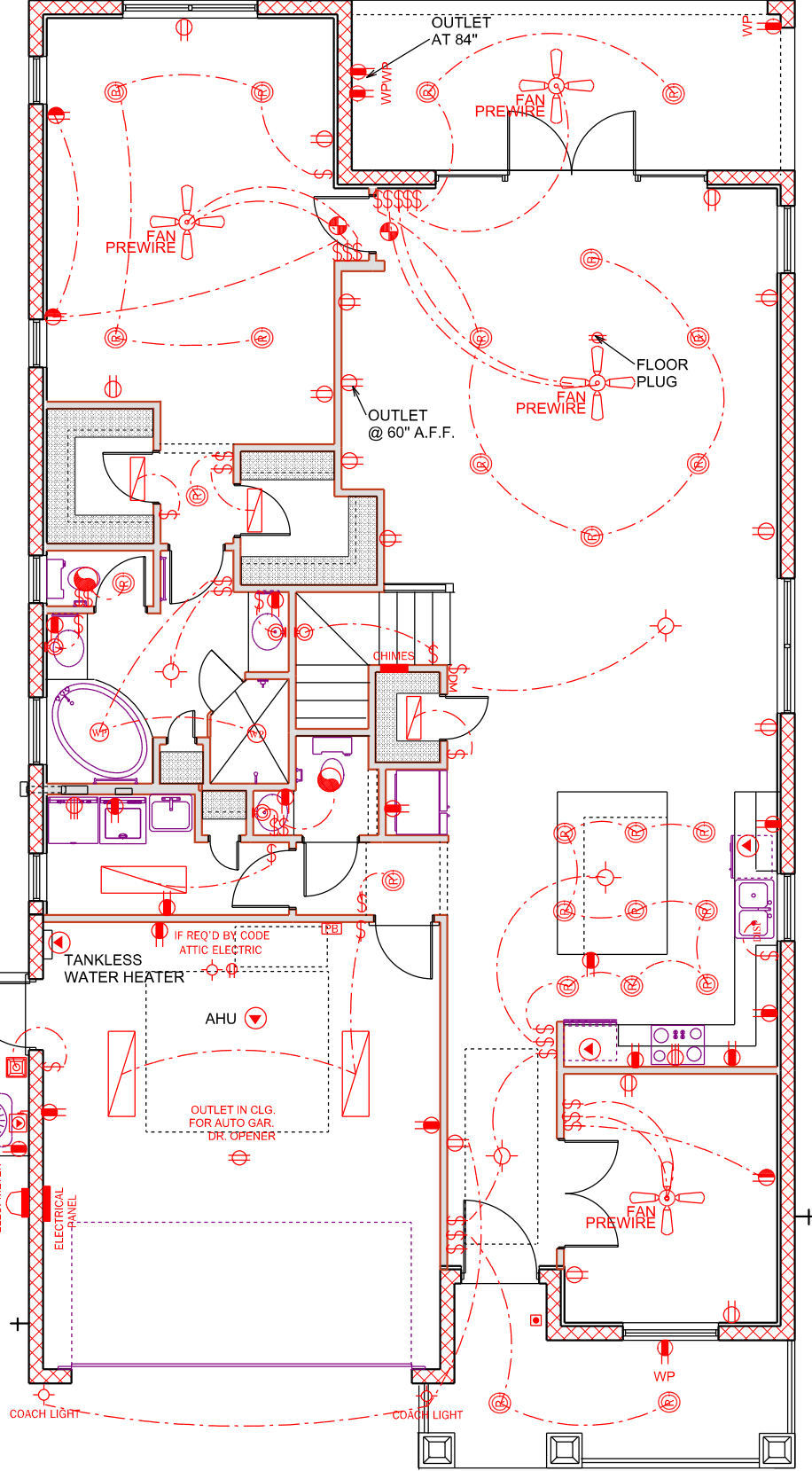

ELECTRICAL PLAN

SCALE 1/8" = 1'-0"

A.E.C.S. 16016

7

INVENTORY RESIDENCE  
LOT 12  
SAFETY HARBOR, FL.

PLAN DATE

4-29-2016	1-20-2016
5-23-2016	8-1-2016
6-01-2016	
6-13-2016	

INVENTORY RESIDENCE  
LOT 12  
SAFETY HARBOR, FL.

INVENTORY RESIDENCE  
LOT 12  
SAFETY HARBOR, FL.