

ELECTRICAL LEGEND

- \$ SINGLE POLE SWITCH
- \$2 DOUBLE POLE SWITCH
- \$3 THREE-WAY SWITCH
- \$4 FOUR-WAY SWITCH
- \$DM DIMMER SWITCH
- ☉ CEILING FIXTURE
- ☉ SCOUNCE (WALL MOUNTED) FIXTURE
- 110 VOLT DUPLEX OUTLET
- 110 VOLT SPLIT SWITCHED OUTLET
- ⊕ GROUND FAULT INTERRUPT
- WP WATER PROOF W/ GROUND FAULT
- 220 VOLT OUTLET
- ⊕ SPECIAL SERVICES OUTLET
- TV T.V. CABLE OUTLET
- ☎ TELEPHONE CABLE OUTLET
- ⊕ RECESSED LIGHTING
- ⊕ WATER PROOF RECESSED LIGHTING
- ⊕ BATH FAN
- ⊕ BATH FAN W/ LIGHT
- ☉ SMOKE DETECTOR/CARBON MONOXIDE DETECTOR
- ☉ FLOOD LIGHT
- ☉ FLUORESCENT LIGHTING
- ☉ TRACK LIGHTING
- ☉ CEILING FAN
- ☉ CHIMES
- ☉ DOOR BELL CHIMES
- ☉ DOOR BELL
- ☉ DISPOSAL
- ☉ DISCONNECT SWITCH
- SP PREWIRE SPEAKER
- JUNCTION BOX
- T THERMOSTAT
- ⊕ LOW VOLTAGE LIGHTING
- IC INTERCOM SYSTEM
- ⊕ GARAGE DOOR PUSH BUTTON

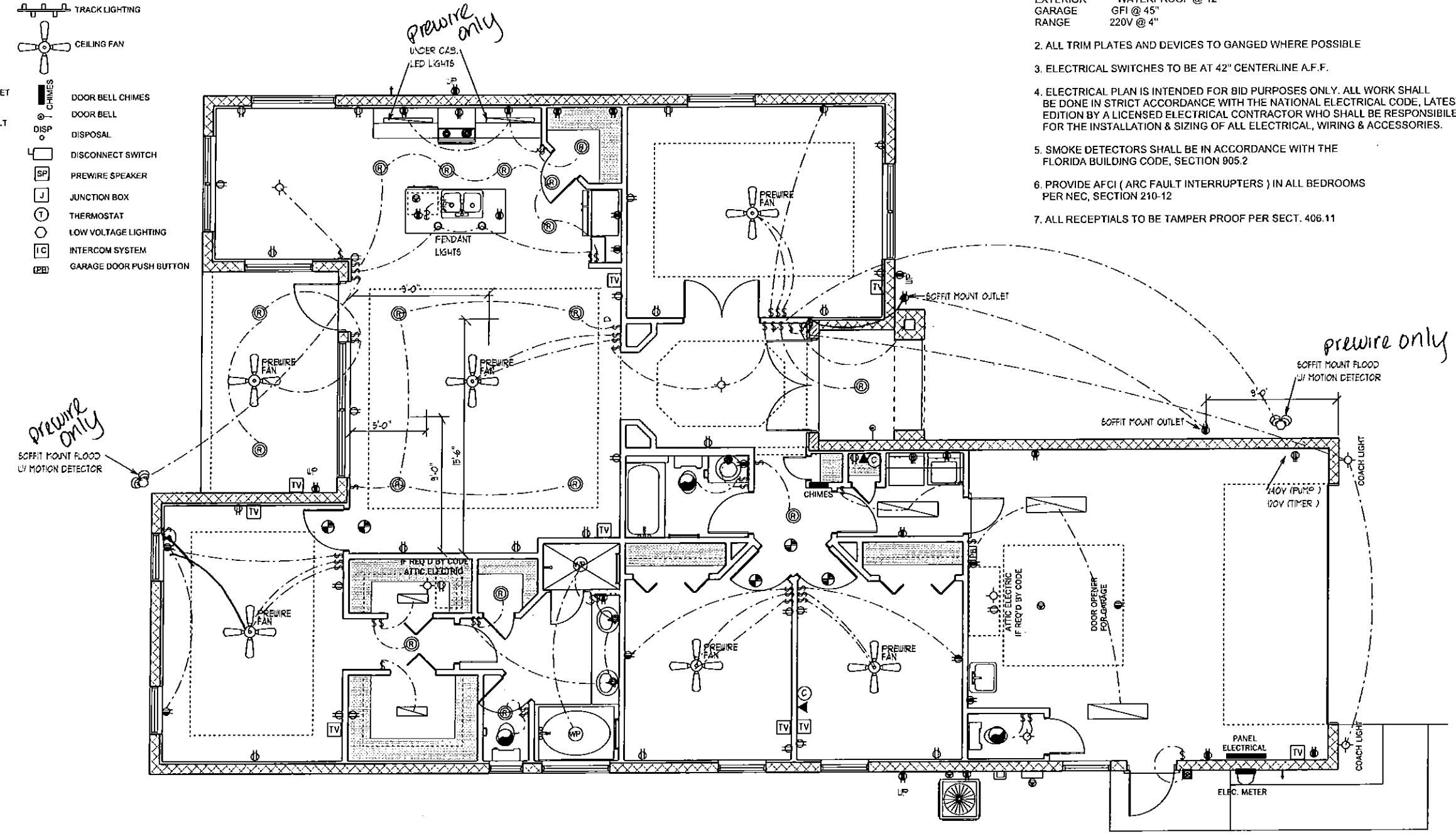

NOTES:

UNLESS OTHERWISE NOTED
 1. ELECTRICAL OUTLET HEIGHTS MEASURED FROM FINISHED FLOOR TO CENTERLINE OF THE BOX TO BE 16" A.F.F. (GENERAL)

- KITCHEN 42"
- BATHROOM 42"
- LAUNDRY 36" WASHER/ 24" DRYER/ WALL OUTLETS 45"
- EXTERIOR WATERPROOF @ 12"
- GARAGE GFI @ 45"
- RANGE 220V @ 4"

- 2. ALL TRIM PLATES AND DEVICES TO BE GANGED WHERE POSSIBLE
- 3. ELECTRICAL SWITCHES TO BE AT 42" CENTERLINE A.F.F.
- 4. ELECTRICAL PLAN IS INTENDED FOR BID PURPOSES ONLY. ALL WORK SHALL BE DONE IN STRICT ACCORDANCE WITH THE NATIONAL ELECTRICAL CODE, LATEST EDITION BY A LICENSED ELECTRICAL CONTRACTOR WHO SHALL BE RESPONSIBLE FOR THE INSTALLATION & SIZING OF ALL ELECTRICAL, WIRING & ACCESSORIES.
- 5. SMOKE DETECTORS SHALL BE IN ACCORDANCE WITH THE FLORIDA BUILDING CODE, SECTION 905.2
- 6. PROVIDE AFCI (ARC FAULT INTERRUPTERS) IN ALL BEDROOMS PER NEC, SECTION 210-12
- 7. ALL RECEPTALS TO BE TAMPER PROOF PER SECT. 406.11

ELECTRICAL PLAN SCALE 1/8" = 1' 0" A.E.C.S. 16003 **PEBBLE BEACH 2150**

DEEB FAMILY HOMES, LTD.
 9400 RIVER CROSSING BLVD.
 NEW PORT RICHEY, FL. 34655

PARKER RESIDENCE
 8591 FORSYTH DR. N
 PINELLAS COUNTY

PLAN DATE
 12-21-2015
 01-05-2016
 03-24-2016
 05-3-2016

ALLEN ENGINEERING & CONSTRUCTION SERVICES
 RICH ALLEN PROFESSIONAL ENGINEER
 P.E. # 56920 C.A. # 9542
 P.O. BOX 351
 NEW PORT RICHEY, FL. 34656
 727-842-6100
 richallenpe@gmail.com

I HEREBY CERTIFY THAT I HAVE PERFORMED THE ATTACHED DESIGN TO COMPLY WITH THE MINIMUM REQUIREMENTS AS SET FORTH IN THE FLORIDA RESIDENTIAL BUILDING CODE, SECT. 905.2 AND 905.3. I AM A LICENSED PROFESSIONAL ENGINEER IN THE STATE OF FLORIDA.
 SIGNED: RICHARD E. ALLEN P.E. #56920

