

UNLESS OTHERWISE NOTED
 1. ELECTRICAL OUTLET HEIGHTS MEASURED FROM FINISHED FLOOR TO CENTERLINE OF THE BOX TO BE 18" A.F.F. (GENERAL)
 KITCHEN 42"
 BATHROOM 42"
 LAUNDRY 36" WASHERS/ 24" DRYERS/ WALL OUTLETS 48"
 EXTERIOR WATERPROOF 12"
 GARAGE GFI 48"
 RANGE 20V 42"

2. ALL TRIM PLATES AND DEVICES TO BE GANGED WHERE POSSIBLE
 3. ELECTRICAL SWITCHES TO BE AT 42" CENTERLINE A.F.F.

4. ELECTRICAL PLAN IS INTENDED FOR BID PURPOSES ONLY. ALL WORK SHALL BE DONE IN STRICT ACCORDANCE WITH THE NATIONAL ELECTRICAL CODE LATEST EDITION BY A LICENSED ELECTRICAL CONTRACTOR WHO SHALL BE RESPONSIBLE FOR THE INSTALLATION / SIZING OF ALL ELECTRICAL WIRING / ACCESSORIES.
 5. SMOKE DETECTORS SHALL BE IN ACCORDANCE WITH THE FLORIDA BUILDING CODE, SECTION 907.2
 6. PROVIDE AFCI / ARC FAULT INTERRUPTERS / THRU OUT PER NEC, SECTION 210-12
 7. ALL RECEPTALS TO BE TAMPER PROOF PER SECT. 406.11

in ceiling

- ELECTRICAL LEGEND**
- \$ SINGLE POLE SWITCH
 - \$2 DOUBLE POLE SWITCH
 - \$3 THREE-WAY SWITCH
 - \$4 FOUR-WAY SWITCH
 - \$DM DIMMER SWITCH
 - ⊕ CEILING FIXTURE
 - ⊖ SCOUNCE (WALL MOUNTED) FIXTURE
 - ⊕ 110 VOLT DUPLEX OUTLET
 - ⊕ 110 VOLT SPLIT SWITCHED OUTLET
 - ⊕ GROUND FAULT INTERRUPT
 - ⊕ WP WATER PROOF W/ GROUND FAULT
 - ⊕ 220 VOLT OUTLET
 - TV T.V. CABLE OUTLET
 - ☎ TELEPHONE CABLE OUTLET
 - ⊕ RECESSED LIGHTING
 - ⊕ WATER PROOF RECESSED LIGHTING
 - ⊕ BATH FAN
 - ⊕ BATH FAN W/ LIGHT
 - ⊕ SMOKE DETECTOR / CARBON MONOXIDE DETECTOR
 - ⊕ FLOOD LIGHT
 - ⊕ FLUORESCENT LIGHTING
 - ⊕ TRACK LIGHTING
 - ⊕ CEILING FAN
 - ⊕ CHIMES
 - ⊕ DOOR BELL CHIMES
 - ⊕ DOOR BELL
 - ⊕ DISPOSAL
 - ⊕ DISCONNECT SWITCH
 - ⊕ PREWIRE SPEAKER
 - ⊕ JUNCTION BOX
 - ⊕ THERMOSTAT
 - ⊕ LOW VOLTAGE LIGHTING
 - ⊕ INTERCOM SYSTEM
 - ⊕ GARAGE DOOR PUSH BUTTON

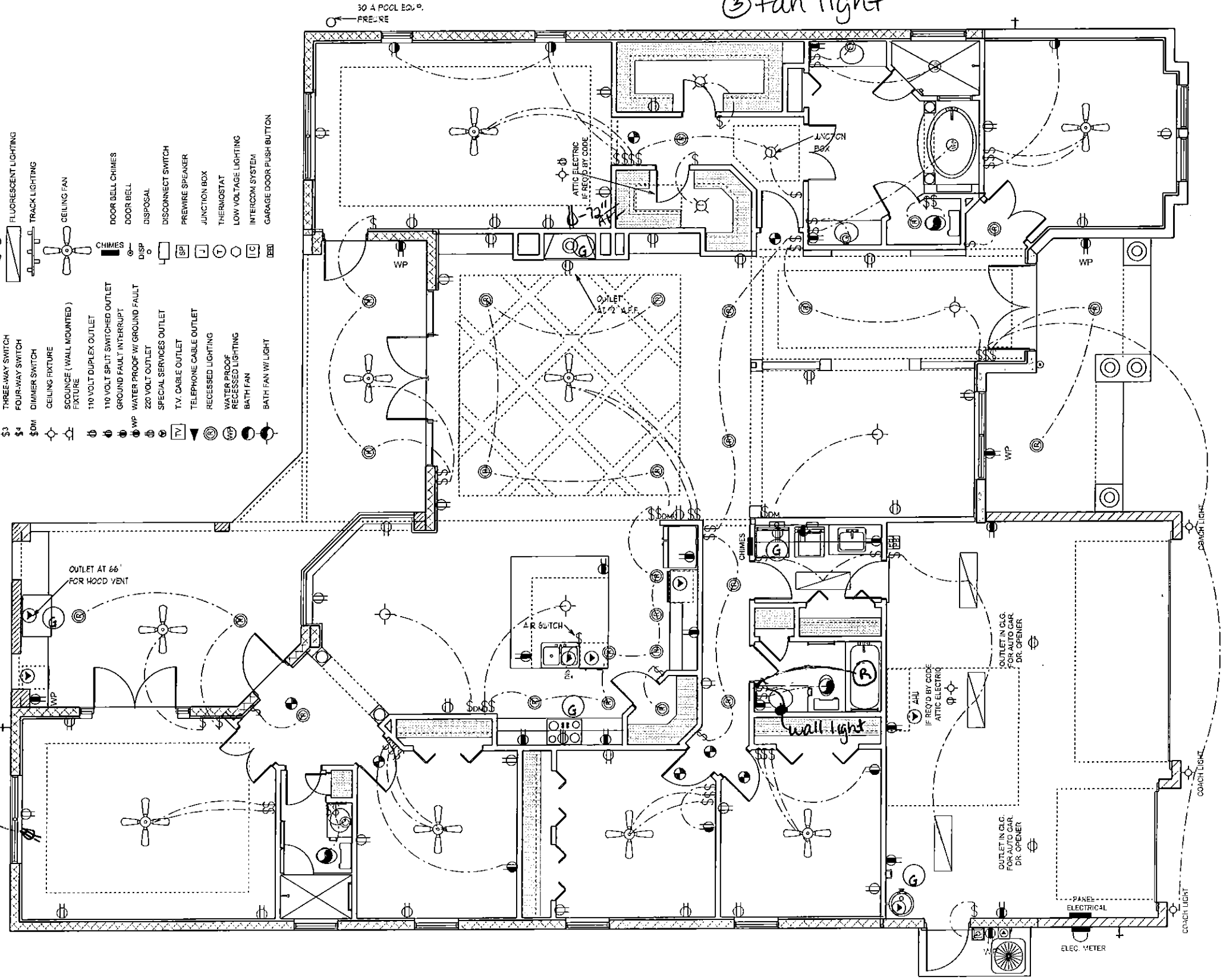

order of all bedroom + study switches (starting closest to door):
 ① wall outlet
 ② fan
 ③ fan light

ELECTRICAL PLAN

SCALE 1/8" = 1' 0"

WILLOW 3408

A.E.C.S. 16010

DEEB FAMILY HOMES, LTD.
 9400 RIVER CROSSING BLD.
 NEW PORT RICHEY, FL 34655
 727-376-8831

PLAN DATE
5-31-2016
6-2-2016
6-13-2016

TUZZU RESIDENCE
 LOT 22 MAJESTIC OAKS
 PINELLAS COUNTY, FL.

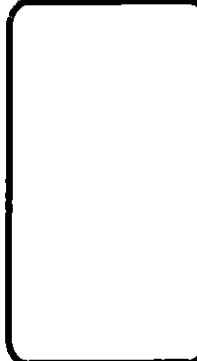

7