

WALL LEGEND

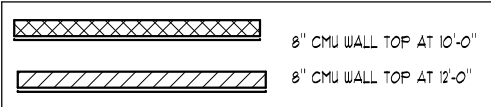

SQUARE FOOTAGES

LIVING AREA	- 3408 S.F.
GARAGE	- 656 S.F.
LANAI	- 470 S.F.
ENTRY	- 143 S.F.
TOTAL	- 4667 S.F.

FIRST FLOOR NOTES

DEEB FAMILY HOMES, LTD.
 9400 RIVER CROSSING BLD.
 NEW PORT RICHEY, FL. 34655
 727-376-6831

2

SCALE 1/8" = 1'-0"

PLAN DATE	DATE
5-21-2014	8-1-2014
6-3-2014	8-12-2014
6-5-2014	9-4-2014
6-18-2014	9-24-2014
7-22-2014	10-2-2014

INVENTORY LOT 43 MAJESTIC OAKS

I HEREBY CERTIFY THAT I HAVE PERFORMED THE ATTACHED DESIGN TO COMPLY WITH 145 MPH ULTIMATE WIND LOADS AND IT IS IN COMPLIANCE WITH SECT. 301 OF THE 2010 FLORIDA BUILDING CODE. THIS PLAN IS SEALED FOR STRUCTURE ONLY.

SIGNED
 RICHARD E. ALLEN P.E. #56920

A.E.C.S. 14056

WILLOW 3408

ALLEN ENGINEERING & CONSTRUCTION SERVICES
 RICH ALLEN PROFESSIONAL ENGINEER
 P.E. # 56920 C.A.# 9542
 P.O. BOX 351
 NEW PORT RICHEY, FL. 34656
 727-842-6100
 richallenpe@gmail.com