

UNLESS OTHERWISE NOTED
 1. ELECTRICAL OUTLET HEIGHTS MEASURED FROM FINISHED FLOOR
 TIO CENTERLINE OF THE BOX TO BE 18" A.F.F. (GENERAL)

KITCHEN 42"
 BATHROOM 42"
 LAUNDRY 36" WASHER/ 24" DRYER/ WALL OUTLETS 45"
 EXTERIOR WATERPROOF @ 12"
 GARAGE GFI @ 45"
 RANGE 220V @ 4"

2. ALL TRIM PLATES AND DEVICES TO GANGED WHERE POSSIBLE

3. ELECTRICAL SWITCHES TO BE AT 42" CENTERLINE A.F.F.

4. ELECTRICAL PLAN IS INTENDED FOR BID PURPOSES ONLY. ALL WORK SHALL
 BE DONE IN STRICT ACCORDANCE WITH THE NATIONAL ELECTRICAL CODE, LATEST
 EDITION BY A LICENSED ELECTRICAL CONTRACTOR WHO SHALL BE RESPONSIBLE
 FOR THE INSTALLATION & SIZING OF ALL ELECTRICAL, WIRING & ACCESSORIES.

5. SMOKE DETECTORS SHALL BE IN ACCORDANCE WITH THE
 FLORIDA BUILDING CODE, SECTION 907.2

6. PROVIDE AFCI (ARC FAULT INTERRUPTERS) IN ALL BEDROOMS
 PER NEC, SECTION 210-12

7. ALL RECEPTALS TO BE TAMPER PROOF PER SECT. 406.11

ELECTRICAL LEGEND

\$	SINGLE POLE SWITCH	+	SMOKE DETECTOR / CARBON MONOXIDE DETECTOR
\$2	DOUBLE POLE SWITCH	F	FLOOD LIGHT
\$3	THREE-WAY SWITCH	FL	FLUORESCENT LIGHTING
\$4	FOUR-WAY SWITCH	TL	TRACK LIGHTING
\$DM	DIMMER SWITCH	C	CEILING FAN
CF	CEILING FIXTURE	CH	CHIMES
SC	SCOURCE (WALL MOUNTED) FIXTURE	DB	DOOR BELL CHIMES
DO	110 VOLT DUPLEX OUTLET	DB	DOOR BELL
DS	110 VOLT SPLIT SWITCHED OUTLET	DIS	DISPOSAL
GI	GROUND FAULT INTERRUPT	DISC	DISCONNECT SWITCH
WP	WATER PROOF W/ GROUND FAULT	SP	PREWIRE SPEAKER
220	220 VOLT OUTLET	J	JUNCTION BOX
SS	SPECIAL SERVICES OUTLET	T	THERMOSTAT
TV	T.V. CABLE OUTLET	LC	LOW VOLTAGE LIGHTING
TC	TELEPHONE CABLE OUTLET	IC	INTERCOM SYSTEM
R	RECESSED LIGHTING	GB	GARAGE DOOR PUSH BUTTON
WR	WATER PROOF RECESSED LIGHTING		
B	BATH FAN		
BFL	BATH FAN W/ LIGHT		

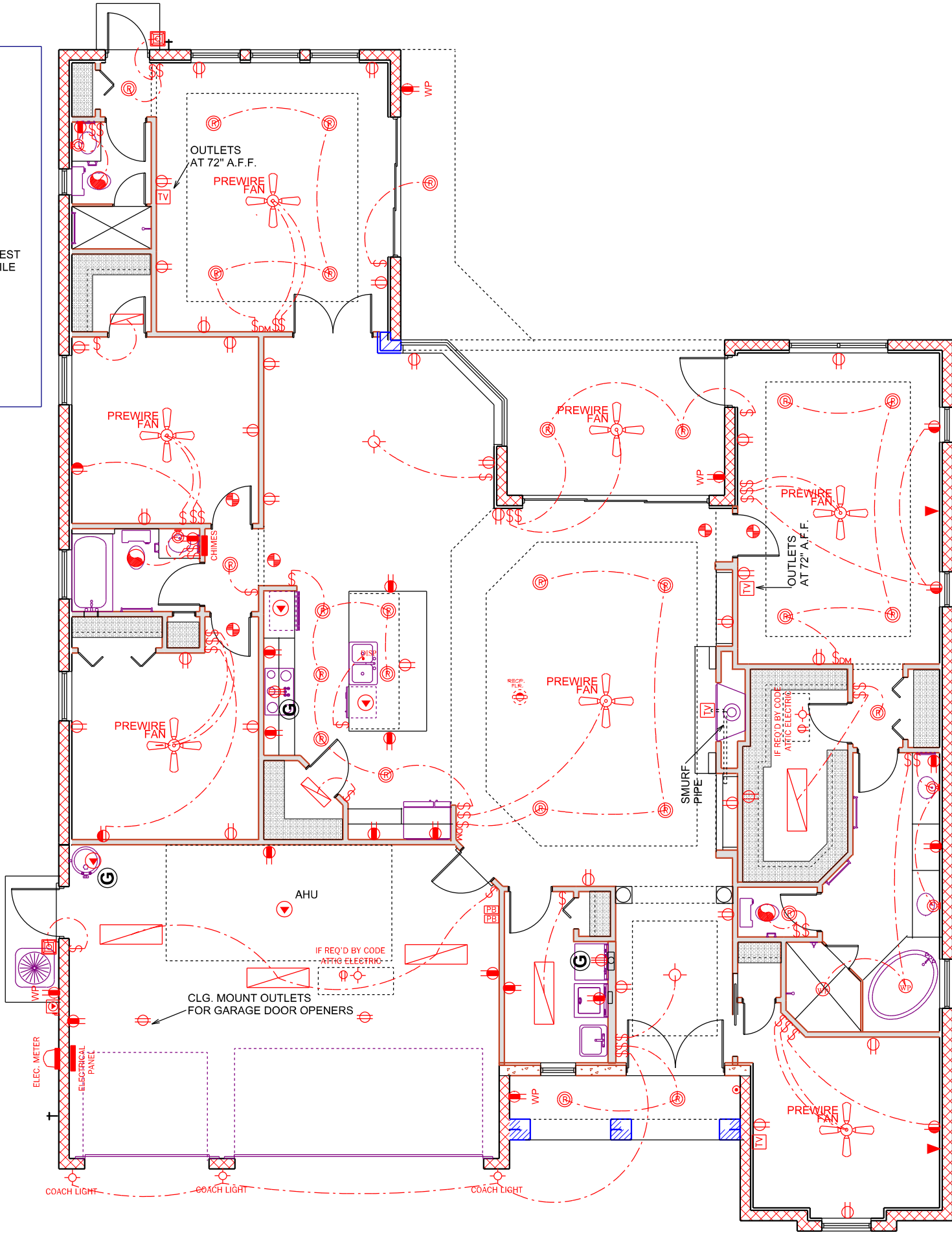

ELECTRICAL PLAN

SCALE 1/8" = 1'-0"

DEEB FAMILY
 HOMES, LTD.
 9400 RIVER CROSSING BLD.
 NEW PORT RICHEY, FL. 34655
 727-376-6831

INVENTORY PROJECT
 LOT 3
 HARBOR HILL PARK

PLAN DATE	8-25-2015
7-30-2015	8-31-2015
8-4-2015	8-31-2015
8-6-2015	8-31-2015
8-11-2015	8-31-2015
8-20-2015	8-31-2015

A.E.C.S. 15078

THESEB CERTIFY THAT I HAVE PERFORMED THE ATTACHED DESIGN TO COMPLY WITH THE ULTIMATE WIND LOADS AND IT IS IN COMPLIANCE WITH SECT. 301 OF THE 2014 FLORIDA RESIDENTIAL BUILDING CODE SEALED FOR STRUCTURE ONLY

SIGNED: RICHARD E. ALLEN P.E. #56820
 richallenpe@gmail.com

UNIT 2700

ALLEN ENGINEERING &
 CONSTRUCTION SERVICES
 RICH ALLEN PROFESSIONAL ENGINEER
 P.E. # 56920 C.A. # 9542

P.O. BOX 351
 NEW PORT RICHEY, FL. 34656
 727-842-6100 Fax: 727-825-3973
 richallenpe@gmail.com

7