

UNLESS OTHERWISE NOTED  
 1. ELECTRICAL OUTLET HEIGHTS MEASURED FROM FINISHED FLOOR TO CENTERLINE OF THE BOX TO BE 18" A.F.F. ( GENERAL )  
 KITCHEN 42"  
 BATHROOM 42"  
 LAUNDRY 36" WASHER/ 24" DRYER/ WALL OUTLETS 45"  
 EXTERIOR WATERPROOF @ 12"  
 GARAGE GFI @ 45"  
 RANGE 220V @ 4"  
 2. ALL TRIM PLATES AND DEVICES TO BE GANGED WHERE POSSIBLE  
 3. ELECTRICAL SWITCHES TO BE AT 42" CENTERLINE A.F.F.

4. ELECTRICAL PLAN IS INTENDED FOR BID PURPOSES ONLY. ALL WORK SHALL BE DONE IN STRICT ACCORDANCE WITH THE NATIONAL ELECTRICAL CODE, LATEST EDITION BY A LICENSED ELECTRICAL CONTRACTOR WHO SHALL BE RESPONSIBLE FOR THE INSTALLATION & SIZING OF ALL ELECTRICAL, WIRING & ACCESSORIES.  
 5. SMOKE DETECTORS SHALL BE IN ACCORDANCE WITH THE FLORIDA BUILDING CODE, SECTION 907.2  
 6. PROVIDE AFCI ( ARC FAULT INTERRUPTERS ) IN ALL BEDROOMS PER NEC, SECTION 210-12  
 7. ALL RECEPTALS TO BE TAMPER PROOF PER SECT. 406.11

- ELECTRICAL LEGEND**
- \$ SINGLE POLE SWITCH
  - \$2 DOUBLE POLE SWITCH
  - \$3 THREE-WAY SWITCH
  - \$4 FOUR-WAY SWITCH
  - \$DM DIMMER SWITCH
  - ⊕ CEILING FIXTURE
  - ⊕ SCOUNCE ( WALL MOUNTED ) FIXTURE
  - ⊕ 110 VOLT DUPLEX OUTLET
  - ⊕ 110 VOLT SPLIT SWITCHED OUTLET
  - ⊕ GROUND FAULT INTERRUPT
  - ⊕ WP WATER PROOF W/ GROUND FAULT
  - ⊕ 220 VOLT OUTLET
  - ⊕ SPECIAL SERVICES OUTLET
  - TV T.V. CABLE OUTLET
  - ▲ TELEPHONE CABLE OUTLET
  - ⊕ RECESSED LIGHTING
  - ⊕ WP WATER PROOF RECESSED LIGHTING
  - ⊕ BATH FAN
  - ⊕ BATH FAN W/ LIGHT
  - ⊕ SMOKE DETECTOR / CARBON MONOXIDE DETECTOR
  - ⊕ FLOOD LIGHT
  - ⊕ FLUORESCENT LIGHTING
  - ⊕ TRACK LIGHTING
  - ⊕ CEILING FAN
  - ⊕ CHIMES DOOR BELL CHIMES
  - ⊕ DOOR BELL
  - ⊕ DISPOSAL
  - ⊕ DISCONNECT SWITCH
  - ⊕ PREWIRE SPEAKER
  - ⊕ JUNCTION BOX
  - ⊕ THERMOSTAT
  - ⊕ LOW VOLTAGE LIGHTING
  - ⊕ INTERCOM SYSTEM
  - ⊕ GARAGE DOOR PUSH BUTTON

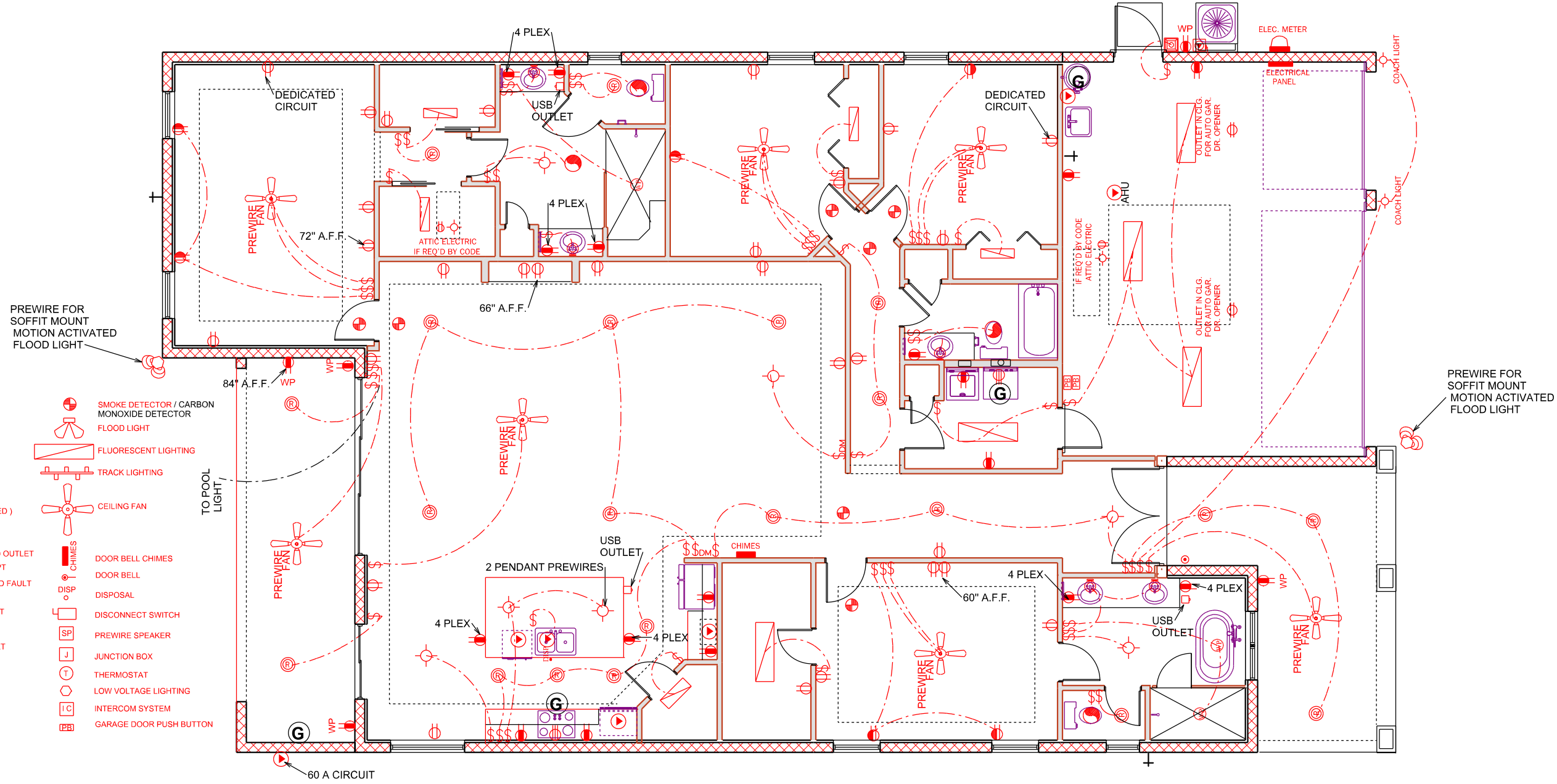

**ELECTRICAL PLAN**

**DEEB FAMILY HOMES, LTD.**  
 9400 RIVER CROSSING BLD.  
 NEW PORT RICHEY, FL. 34655  
 727-376-6831

**PLAN DATE**

05-01-19	06-04-19
05-08-19	06-11-19
05-20-19	06-19-19
05-28-19	

**FISHMAN RESIDENCE**  
**LOT 19- DUNEDIN CIVE**  
**CONCORD DR.**

HEREBY CERTIFY THAT I HAVE PERFORMED THE ATTACHED DESIGN TO COMPLY WITH 145 MPH ULTIMATE WIND LOADS AND IT IS IN COMPLIANCE WITH SECT. 301 OF THE 2017 FLORIDA RESIDENTIAL BUILDING CODE SEALED FOR STRUCTURE ONLY

SIGNED  
 RICHARD E. ALLEN P.E. #56920

**A.E.C.S. 19047**

**MODEL 2749**

**ALLEN ENGINEERING & CONSTRUCTION SERVICES**  
 RICH ALLEN PROFESSIONAL ENGINEER  
 P.E. # 56920 C.A. # 9542  
 8809 SKYMASTER DR  
 NEW PORT RICHEY, FL. 34654  
 727-842-6100  
 richallenpe@gmail.com

**7**