

SQUARE FOOTAGES

LIVING AREA - 2050 S.F.
 GARAGE - 416 S.F.
 LANAI - 85 S.F.
 ENTRY - 66 S.F.

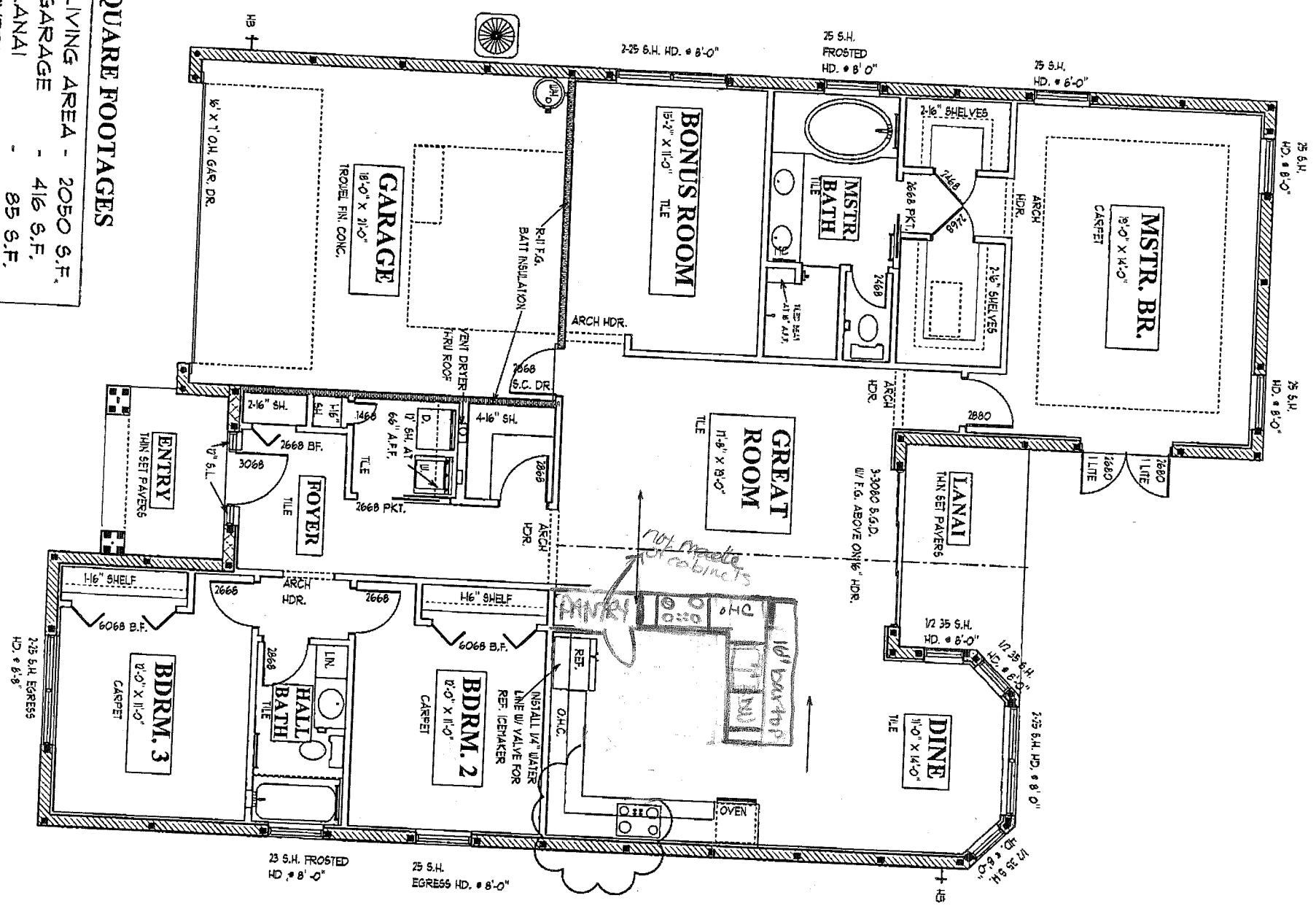

FLOOR PLAN NOTES

SCALE 1/8" = 1' 0"

A.E.C.S. # 13005

HICKORY 2050

2

DEEB FAMILY HOMES, LTD.
 9400 RIVER CROSSING BLD.
 NEW PORT RICHEY, FL. 34655
 727-376-6831

PLAN DATE
1-8-13
1-22-13
2-21-13

INVENTORY
 LOT 3
 COUNTRYSIDE COVE
 CLEARWATER, FL.

I HEREBY CERTIFY THAT I HAVE PERFORMED THE ATTACHED DESIGN TO COMPLY WITH ALL APPLICABLE MINIMUM LOADS AND IT IS IN COMPLIANCE WITH SECT. 901 OF THE 2010 FLORIDA RESIDENTIAL BUILDING CODE SEALED FOR STRUCTURE ONLY.

SIGNED
 RICHARD E. ALLEN P.E. #56220

ALLEN ENGINEERING & CONSTRUCTION SERVICES
 RICH ALLEN PROFESSIONAL ENGINEER
 P.E. # 56920 C.A. # 9542
 P.O. BOX 351
 NEW PORT RICHEY, FL. 34656
 727-842-6100
 richallenpe@gmail.com