

UNLESS OTHERWISE NOTED

1. ELECTRICAL OUTLET HEIGHTS MEASURED FROM FINISHED FLOOR TO CENTERLINE OF THE BOX TO BE 18" A.F.F. (GENERAL)

KITCHEN 48"  
 BATHROOM 48"  
 LAUNDRY 36" WASHER/ 24" DRYER/ WALL OUTLETS 48"  
 EXTERIOR WATERPROOF 18"  
 GARAGE GFI 48"  
 RANGE 20Y 48"

2. ALL TRIM PLATES AND DEVICES TO GANGED WHERE POSSIBLE

3. ELECTRICAL SWITCHES TO BE AT 48" CENTERLINE AFF.

4. ELECTRICAL PLAN IS INTENDED FOR BID PURPOSES ONLY. ALL WORK SHALL BE DONE IN STRICT ACCORDANCE WITH THE NATIONAL ELECTRICAL CODE LATEST EDITION BY A LICENSED ELECTRICAL CONTRACTOR WHO SHALL BE RESPONSIBLE FOR THE INSTALLATION & SIZING OF ALL ELECTRICAL WIRING & ACCESSORIES.

5. SMOKE DETECTORS SHALL BE IN ACCORDANCE WITH THE FLORIDA BUILDING CODE SECTION 9013

6. PROVIDE AFCI (ARC FAULT INTERRUPTERS) IN ALL BEDROOMS PER NEC. SECTION 210-12

7. ALL RECEPTICALS TO BE TAMPER PROOF PER SECT. 406.11

- ELECTRICAL LEGEND**
- \$ SINGLE POLE SWITCH
  - \$2 DOUBLE POLE SWITCH
  - \$3 THREEWAY SWITCH
  - \$4 FOURWAY SWITCH
  - \$OM DIMMER SWITCH
  - ⊕ CEILING FIXTURE
  - ⊕ SCOURGE (WALL MOUNTED) FIXTURE
  - ⊕ 110 VOLT DUPLEX OUTLET
  - ⊕ 110 VOLT SPLIT SWITCHED OUTLET
  - ⊕ GROUND FAULT INTERRUPT
  - ⊕ W/P WATER PROOF W/ GROUND FAULT
  - ⊕ 220 VOLT OUTLET
  - ⊕ SPECIAL SERVICES OUTLET
  - TV T.V. CABLE OUTLET
  - ⊕ TELEPHONE CABLE OUTLET
  - ⊕ RECESSED LIGHTING
  - ⊕ WATER PROOF RECESSED LIGHTING
  - ⊕ BATH FAN W/ LIGHT
  - ⊕ SMOKE DETECTOR / CARBON MONOXIDE DETECTOR
  - ⊕ FLOOD LIGHT
  - ⊕ FLUORESCENT LIGHTING
  - ⊕ TRACK LIGHTING
  - ⊕ CEILING FAN
  - ⊕ DOOR BELL CHIMES
  - ⊕ DOOR BELL
  - ⊕ DISPOSAL
  - ⊕ DISCONNECT SWITCH
  - ⊕ PREWIRED SPEAKER
  - ⊕ JUNCTION BOX
  - ⊕ THERMOSTAT
  - ⊕ LOW VOLTAGE LIGHTING
  - ⊕ INTERCOM SYSTEM
  - ⊕ GARAGE DOOR PUSH BUTTON

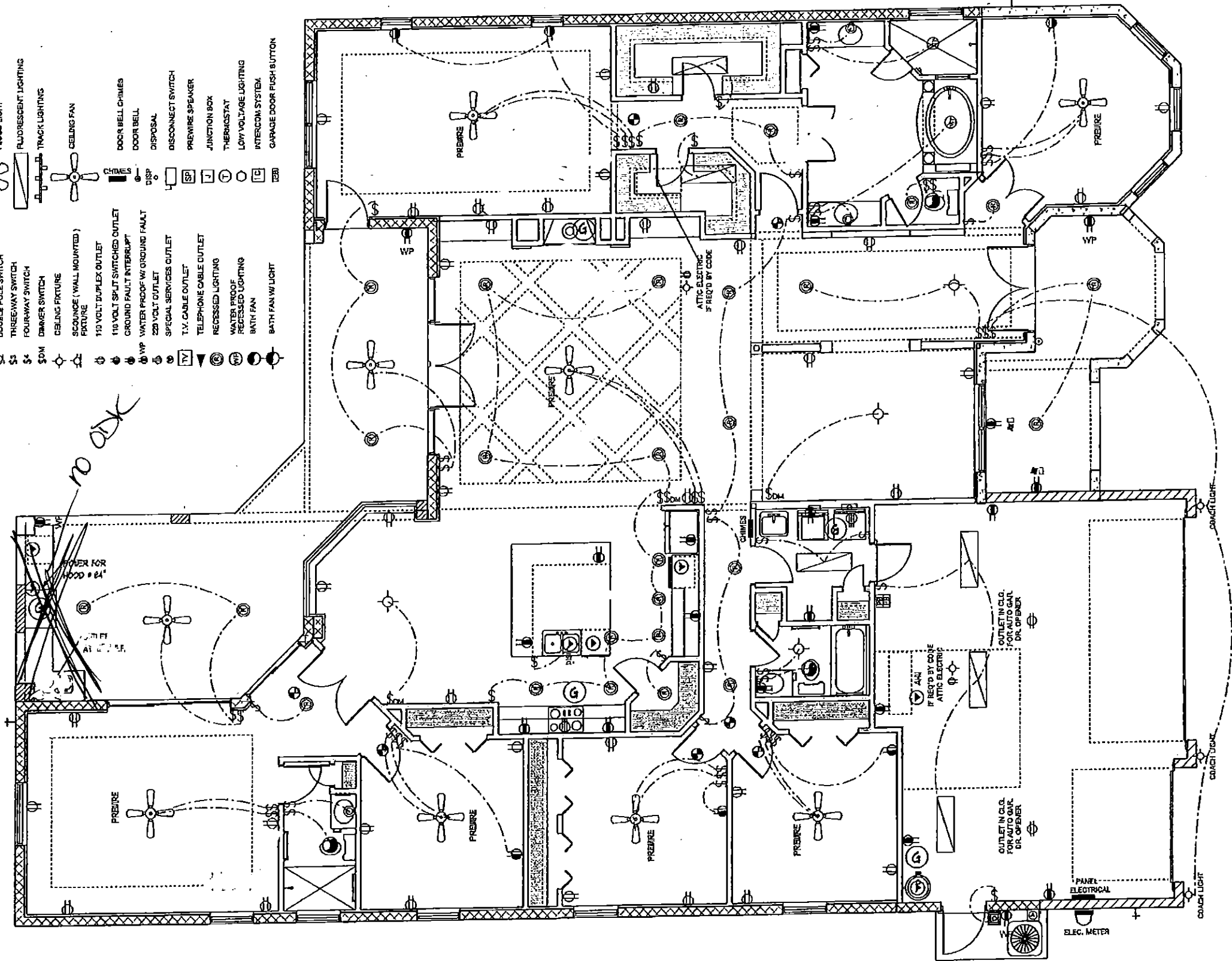

Base electric plan

ELECTRICAL PLAN SCALE 1/8" = 1' 0" A.E.C.S. 15098 WILLOW 3415

7

DEEB FAMILY HOMES, LTD.  
 9408 RIVER CROSSING BLD.  
 NEW PORT RICHEY, FL. 34655  
 727-376-0831

PLAN DATE
11-11-2015
11-18-2015
11-24-2015

INVENTORY LOT 11 BELLEAIR GRANDE