

UNLESS OTHERWISE NOTED
1. ELECTRICAL OUTLET HEIGHTS MEASURED FROM FINISHED FLOOR TO CENTERLINE OF THE BOX TO BE 18" A.F.F. (GENERAL)

KITCHEN 42"
BATHROOM 42"
LAUNDRY 36" WASHER/24" DRYER/ WALL OUTLETS 46"
EXTERIOR WATERPROOF 12"
GARAGE 61" 46"
RANGE 200" 44"

2. ALL TRIM PLATES AND DEVICES TO BE GANGED WHERE POSSIBLE

3. ELECTRICAL SWITCHES TO BE AT 48" CENTERLINE A.F.F.

4. ELECTRICAL PLAN IS INTENDED FOR BID PURPOSES ONLY. ALL WORK SHALL BE DONE IN STRICT ACCORDANCE WITH THE NATIONAL ELECTRICAL CODE LATEST EDITION BY A LICENSED ELECTRICAL CONTRACTOR WHO SHALL BE RESPONSIBLE FOR THE INSTALLATION & SIZING OF ALL ELECTRICAL WIRING & ACCESSORIES.

5. SMOKE DETECTORS SHALL BE IN ACCORDANCE WITH THE FLORIDA BUILDING CODE SECTION 907.2

6. PROVIDE AFCI (ARC FAULT INTERRUPTERS) IN ALL BEDROOMS PER NEC SECTION 210.9

7. ALL RECEPTALS TO BE TAMPER PROOF PER SECT. 406.11

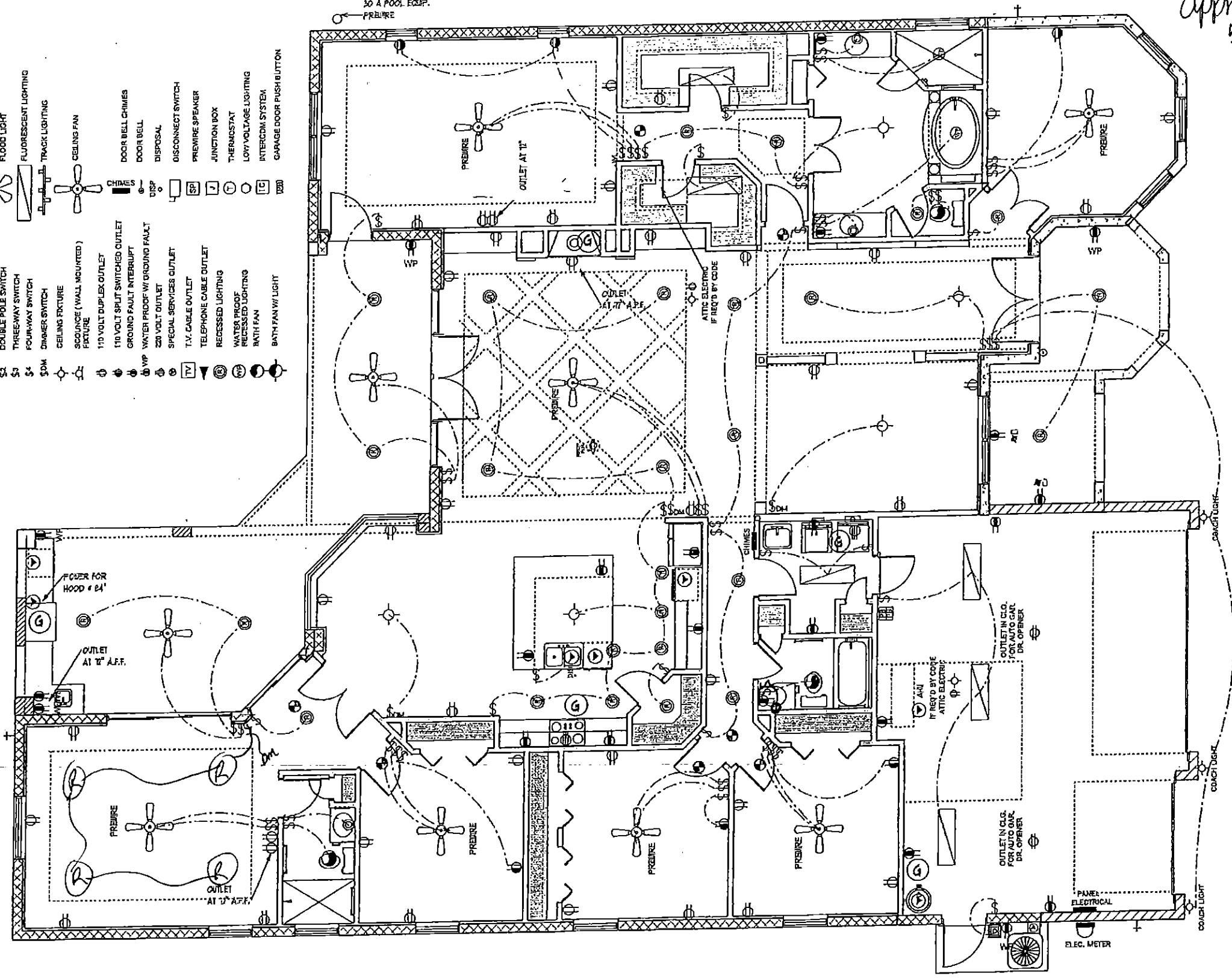
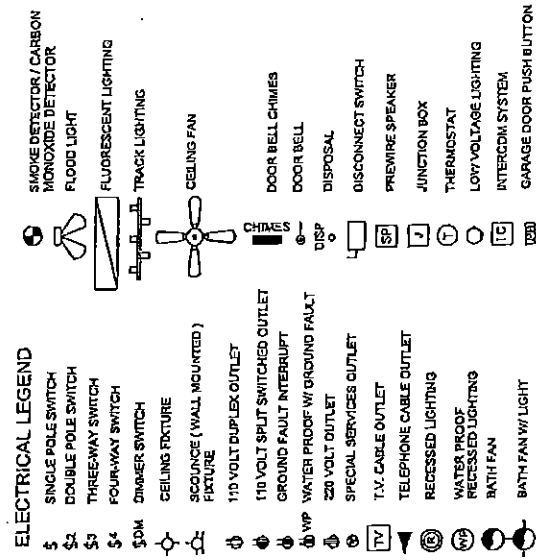

Hang 9 fans
electric approved by NDA 4/6/16

ELECTRICAL PLAN

SCALE 1/8" = 1' 0"

A.E.C.S. 15098

WILLOW 3415

DEEB FAMILY HOMES, LTD.
9400 RIVER CROSSING BLD.
NEW FORT RICHEY, FL 34655
727-376-6831

PLAN DATE
11-11-2015
11-18-2015
11-24-2015

INVENTORY
LOT 11
BELLEAIR GRANDE

7