

**FLOOR PLAN NOTES**

- 1 DRYER VTR IN 6" WALL
- 2 HANSON BOX @ 42" AFF
- 3 12" WIRE SHELF @ 5'-6" AFF
- 4 TOP OF TUB PLATFORM @ 20" AFF
- 5 16" D TILED SHOWER SEAT @ 16" ABV. SHWR FLR
- 6 TOP OF TILED SHELF @ 20" AFF
- 7 TUB ACCESS
- 8 22" X 54" CLG ACCESS
- 9 22" X 36" CLG ACCESS
- 10 (4) 16" SHELVES
- 11 16" SHELF
- 12 TOP OF BAR @ 42" AFF
- 13 TOP OF TEMPERED GLASS SHOWER ENCLOSURE @ 7' AFF
- 14 AIR HANDLER UNIT ON PLATFORM
- 15 AREA OF A/C TRUSSES
- 16 INSTALL 1/4" WATER LINE FOR ICEMAKER
- 17 R-13 BATT INSULATION
- 18 16" W X 6" D FIREPLACE COLUMNS TYP.
- 19 16" WIRE SHELVES @ 40" & 80"
- 20 4- 20" WIRE SHELVES
- 21 12" X 18" HIGH TILED RECESS . BTM .AT 54" A.F.F.

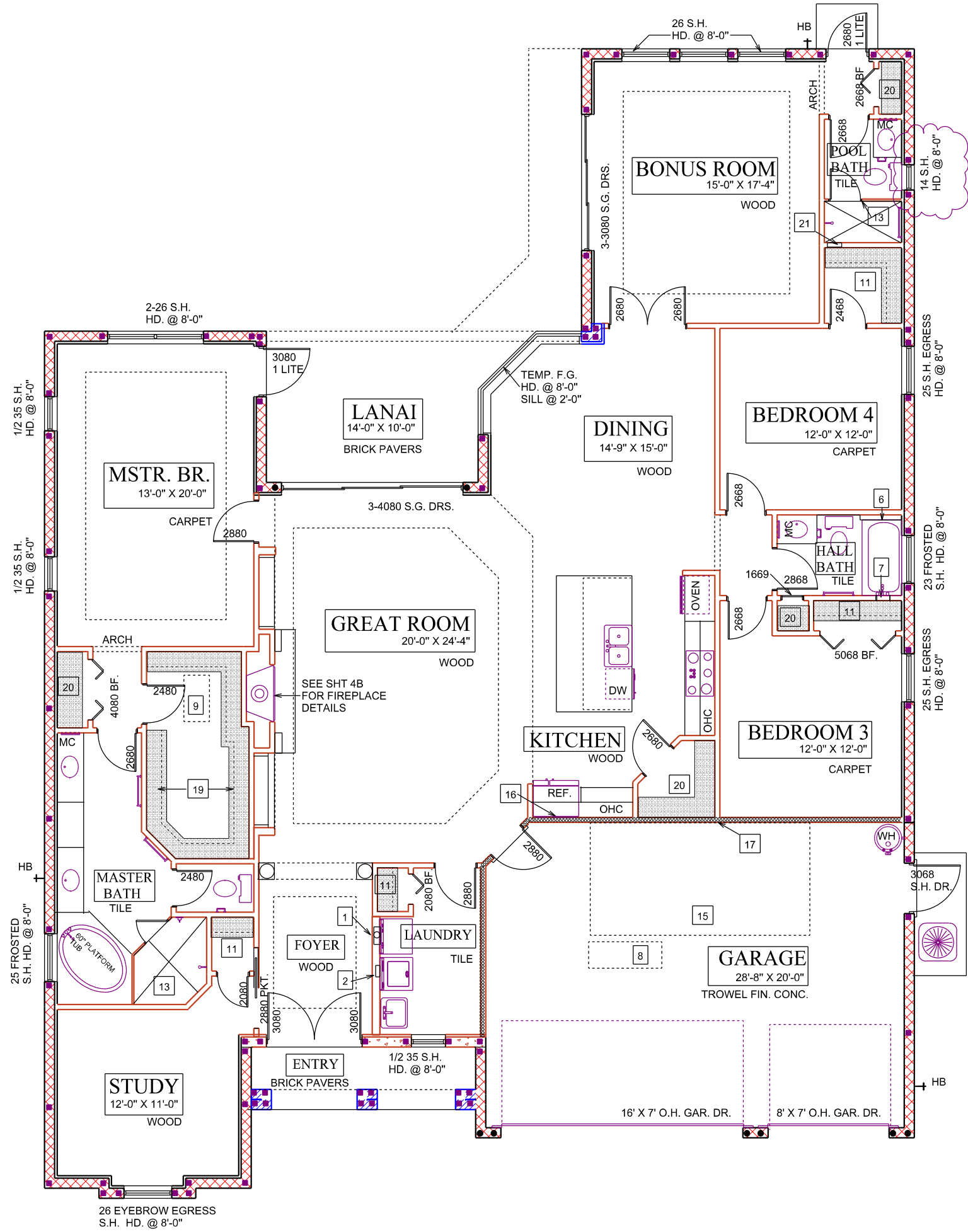

**SQUARE FOOTAGES**

LIVING AREA-	2700 S.F.
GARAGE	- 591 S.F.
LANAI	- 222 S.F.
ENTRY	- 62 S.F.
TOTAL	- 3575 S.F.

FLOOR PLAN NOTES

SCALE 1/8" = 1'-0"

**PLAN DATE**

9-11-2015
9-25-2015
11-3-2015
12-4-2015

**DEEB FAMILY HOMES, LTD.**  
 9400 RIVER CROSSING BLD.  
 NEW PORT RICHEY, FL. 34655  
 727-376-6831

**INVENTORY PROJECT**  
**56 EAST LAKE WOODLANDS**  
**UNIT ONE**

**A.E.C.S. 15080**  
THESE CERTIFICATES HAVE BEEN PREPARED BY ME OR UNDER MY CLOSE PERSONAL SUPERVISION AND TO THE BEST OF MY KNOWLEDGE AND BELIEF THEY COMPLY WITH ALL APPLICABLE REQUIREMENTS OF THE FLORIDA BUILDING CODE AND I AM NOT PROVIDING ANY GUARANTEE OR WARRANTY, EXPRESS OR IMPLIED, FOR THE ACCURACY OF THE INFORMATION CONTAINED HEREIN.  
 SIGNED: RICHARD E. ALLEN P.E. #66920

**UNIT 2700**  
**ALLEN ENGINEERING & CONSTRUCTION SERVICES**  
**RICH ALLEN PROFESSIONAL ENGINEER**  
 P.E. # 56920 C.A. # 9542  
 P.O. BOX 351  
 NEW PORT RICHEY, FL. 34656  
 727-842-6100 Fax: 727-825-3973  
 richallenpe@gmail.com

**2**