

UNLESS OTHERWISE NOTED  
 1. ELECTRICAL OUTLET HEIGHTS MEASURED FROM FINISHED FLOOR  
 TO CENTERLINE OF THE BOX TO BE 18" A.F.F. ( GENERAL )

KITCHEN 42"  
 BATHROOM 42"  
 LAUNDRY 36" WASHER/ 24" DRYER/ WALL OUTLETS 45"  
 EXTERIOR WATERPROOF @ 12"  
 GARAGE GFI @ 45"  
 RANGE 220V @ 4"

2. ALL TRIM PLATES AND DEVICES TO GANGED WHERE POSSIBLE

3. ELECTRICAL SWITCHES TO BE AT 42" CENTERLINE A.F.F.

4. ELECTRICAL PLAN IS INTENDED FOR BID PURPOSES ONLY. ALL WORK SHALL  
 BE DONE IN STRICT ACCORDANCE WITH THE NATIONAL ELECTRICAL CODE, LATEST  
 EDITION BY A LICENSED ELECTRICAL CONTRACTOR WHO SHALL BE RESPONSIBLE  
 FOR THE INSTALLATION & SIZING OF ALL ELECTRICAL, WIRING & ACCESSORIES.

5. SMOKE DETECTORS SHALL BE IN ACCORDANCE WITH THE  
 FLORIDA BUILDING CODE, SECTION 907.2

6. PROVIDE AFCI ( ARC FAULT INTERRUPTERS ) IN ALL BEDROOMS  
 PER NEC, SECTION 210-12

7. ALL RECEPTICALS TO BE TAMPER PROOF PER SECT. 406.11

**ELECTRICAL LEGEND**

- |      |                                  |   |   |
|------|----------------------------------|---|---|
| \$   | SINGLE POLE SWITCH               | ⊕ | SMOKE DETECTOR / CARBON MONOXIDE DETECTOR |
| \$2  | DOUBLE POLE SWITCH               | ☀ | FLOOD LIGHT                               |
| \$3  | THREE-WAY SWITCH                 | ⎓ | FLUORESCENT LIGHTING                      |
| \$4  | FOUR-WAY SWITCH                  | ⎓ | TRACK LIGHTING                            |
| \$DM | DIMMER SWITCH                    | ⊕ | CEILING FAN                               |
| ⊕    | CEILING FIXTURE                  | ⊕ | CEILING FAN                               |
| ⊕    | SCOUNCE ( WALL MOUNTED ) FIXTURE | ⊕ | CHIMES                                    |
| ⊕    | 110 VOLT DUPLEX OUTLET           | ⊕ | DOOR BELL CHIMES                          |
| ⊕    | 110 VOLT SPLIT SWITCHED OUTLET   | ⊕ | DOOR BELL                                 |
| ⊕    | GROUND FAULT INTERRUPT           | ⊕ | DISPOSAL                                  |
| ⊕ WP | WATER PROOF W/ GROUND FAULT      | ⊕ | DISCONNECT SWITCH                         |
| ⊕    | 220 VOLT OUTLET                  | ⊕ | PREWIRE SPEAKER                           |
| ⊕    | SPECIAL SERVICES OUTLET          | ⊕ | JUNCTION BOX                              |
| TV   | T.V. CABLE OUTLET                | ⊕ | THERMOSTAT                                |
| ☎    | TELEPHONE CABLE OUTLET           | ⊕ | LOW VOLTAGE LIGHTING                      |
| ⊕    | RECESSED LIGHTING                | ⊕ | INTERCOM SYSTEM                           |
| ⊕ WP | WATER PROOF RECESSED LIGHTING    | ⊕ | GARAGE DOOR PUSH BUTTON                   |
| ⊕    | BATH FAN                         |   |   |
| ⊕    | BATH FAN W/ LIGHT                |   |   |

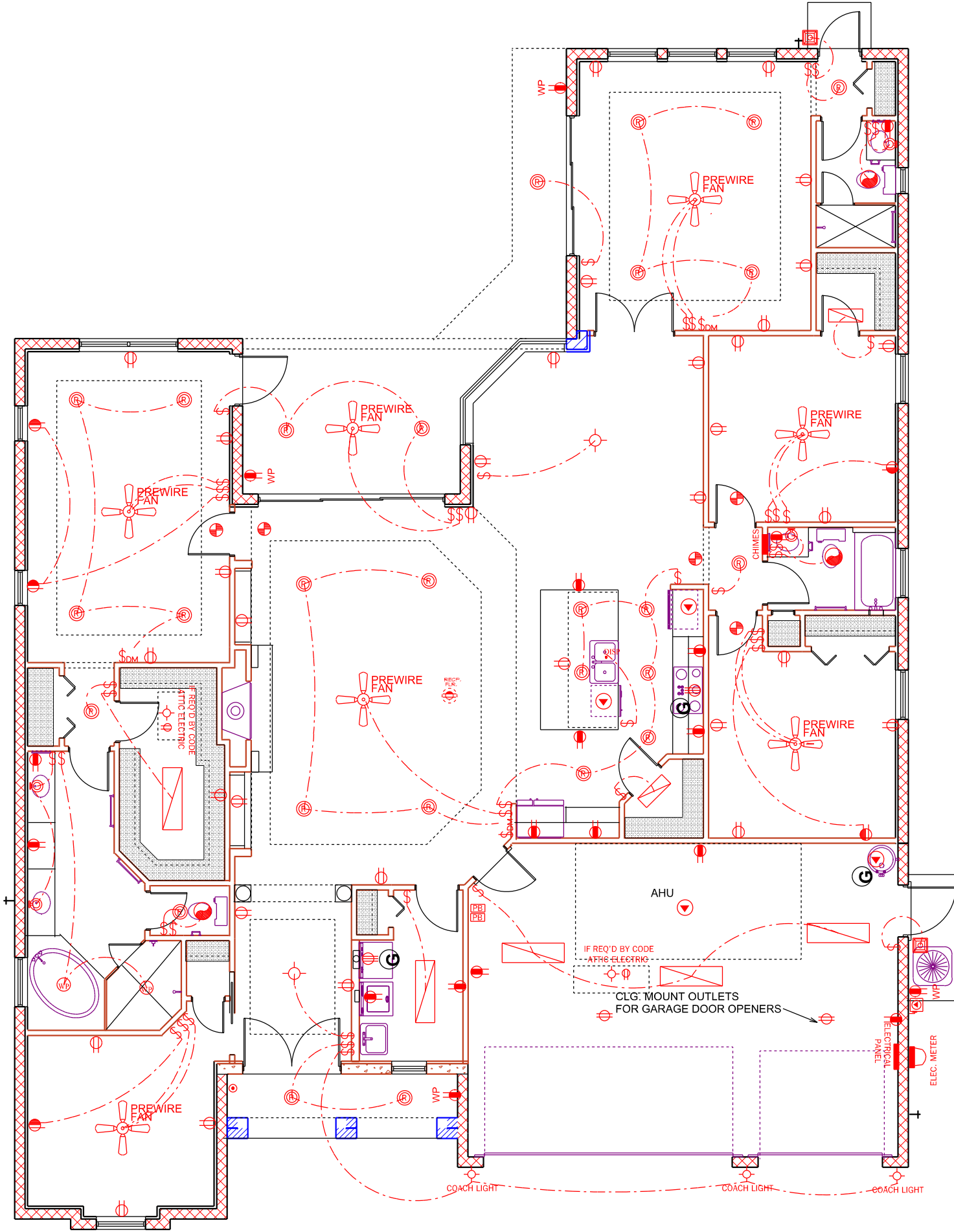

**ELECTRICAL PLAN**

SCALE 1/8" = 1'-0"

**UNIT 2700**

**A.E.C.S. 15080**

**INVENTORY PROJECT**  
**56 EAST LAKE WOODLANDS**  
**UNIT ONE**

**PLAN DATE**

9-11-2015
9-25-2015
11-3-2015

**DEEB FAMILY HOMES, LTD.**  
 9400 RIVER CROSSING BLD.  
 NEW PORT RICHEY, FL. 34655  
 727-376-6831

**ALLEN ENGINEERING & CONSTRUCTION SERVICES**  
**RICH ALLEN PROFESSIONAL ENGINEER**  
 P.E. # 56920 C.A. # 9542  
 P.O. BOX 351  
 NEW PORT RICHEY, FL. 34656  
 727-842-6100 Fax: 727-825-3973  
 richallenpe@gmail.com

I HEREBY CERTIFY THAT I HAVE PERFORMED THE ATTACHED DESIGN TO COMPLY WITH THE MINIMUM REQUIREMENTS AND IT IS IN COMPLIANCE WITH SECT. 301 OF THE 2014 FLORIDA RESIDENTIAL BUILDING CODE SEALED FOR STRUCTURE ONLY  
 SIGNED: RICHARD E. ALLEN P.E. #6620