

UNLESS OTHERWISE NOTED

4. ELECTRICAL PLAN IS INTENDED FOR BID PURPOSES ONLY. ALL WORK SHALL BE DONE IN STRICT ACCORDANCE WITH THE NATIONAL ELECTRICAL CODE, LATEST EDITION BY A LICENSED ELECTRICAL CONTRACTOR WHO SHALL BE RESPONSIBLE FOR THE INSTALLATION & SIZING OF ALL ELECTRICAL, WIRING & ACCESSORIES.

5. SMOKE DETECTORS SHALL BE IN ACCORDANCE WITH THE FLORIDA BUILDING CODE SECTION 907.12

6. PROVIDE AFCI (ARC FAULT INTERRUPTERS) IN ALL BEDROOMS PER NEC, SECTION 210-12

7. ALL TRIM PLATES AND DEVICES TO BE GANGED WHERE POSSIBLE

8. ELECTRICAL SWITCHES TO BE AT 42" CENTERLINE A.F.F.

- 1. ELECTRICAL OUTLET HEIGHTS MEASURED FROM FINISHED FLOOR TO CENTERLINE OF THE BOX TO BE 18" A.F.F. (GENERAL)
- 2. KITCHEN 42"
- 3. BATHROOM 42"
- 4. LAUNDRY 36" WASHER/24" DRYER/ WALL OUTLETS 45"
- 5. EXTERIOR WATERPROOF 6 1/2"
- 6. GARAGE GFI 6 45"
- 7. RANGE 200V 6 4"

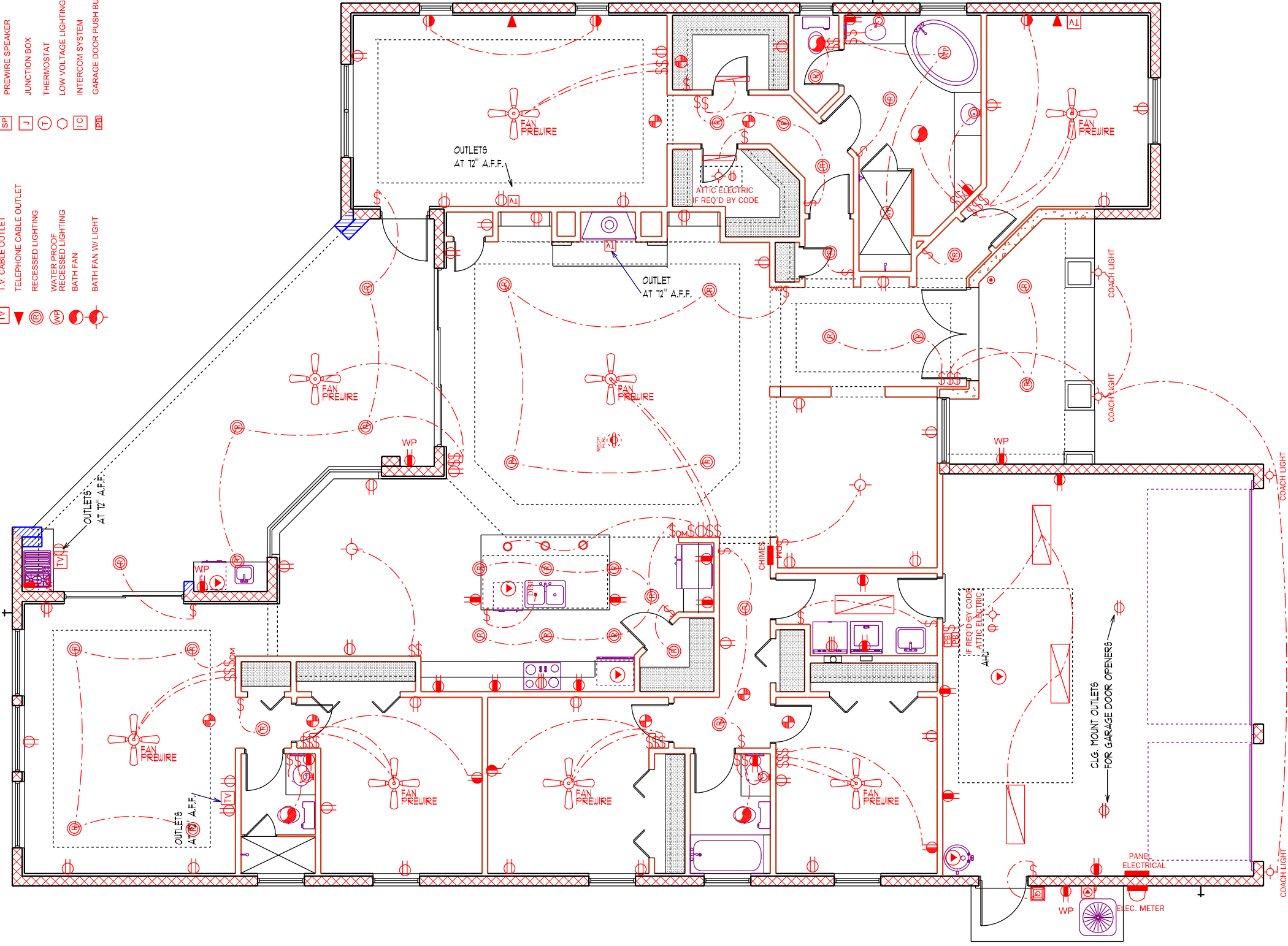
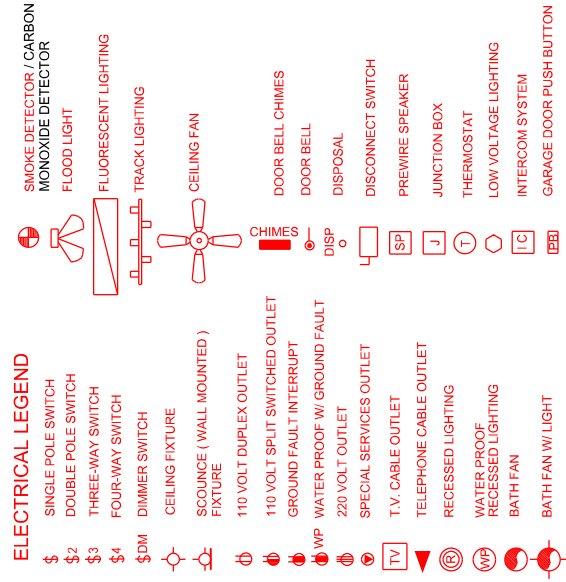

**ELECTRICAL PLAN**

SCALE 1/8" = 1'-0"

**DEEB FAMILY HOMES, LTD.**  
 9400 RIVER CROSSING BLD.  
 NEW PORT RICHEY, FL. 34655  
 727-376-6831

**INVENTORY PROJECT**  
 365 OLD EAST LAKE ROAD  
 PINELLAS COUNTY, FL.

PLAN DATE
1-5-2016
1-11-2016
3-30-2016
3-15-2016

**A.E.C.S. 16002**

I HEREBY CERTIFY THAT I HAVE PERFORMED THE ATTACHED DESIGN TO COMPLY WITH THE ULTIMATE WIND LOADS AND IT IS IN COMPLIANCE WITH SECT. 301 OF THE 2014 FLORIDA RESIDENTIAL BUILDING CODE SEALED FOR STRUCTURE ONLY

SIGNED: RICHARD E. ALLEN P.E. #56920

**WILLOW 3082**

**ALLEN ENGINEERING & CONSTRUCTION SERVICES**  
 RICH ALLEN PROFESSIONAL ENGINEER  
 P.E. # 56920 C.A. # 9542

P.O. BOX 351  
 NEW PORT RICHEY, FL. 34656  
 727-842-6100  
 richallenpe@gmail.com